

# JOHN THE BAPTIST COMMUNITY SCHOOL

CAMPUS PLAN 2020/21



**First Year Campus:**  
office behind Galaxy

**ISOLATION ROOMS**

**5<sup>th</sup>/6<sup>th</sup> Year Campus:**  
Referee's Room

**2<sup>nd</sup>/3<sup>rd</sup> Year:**  
First Aid Room

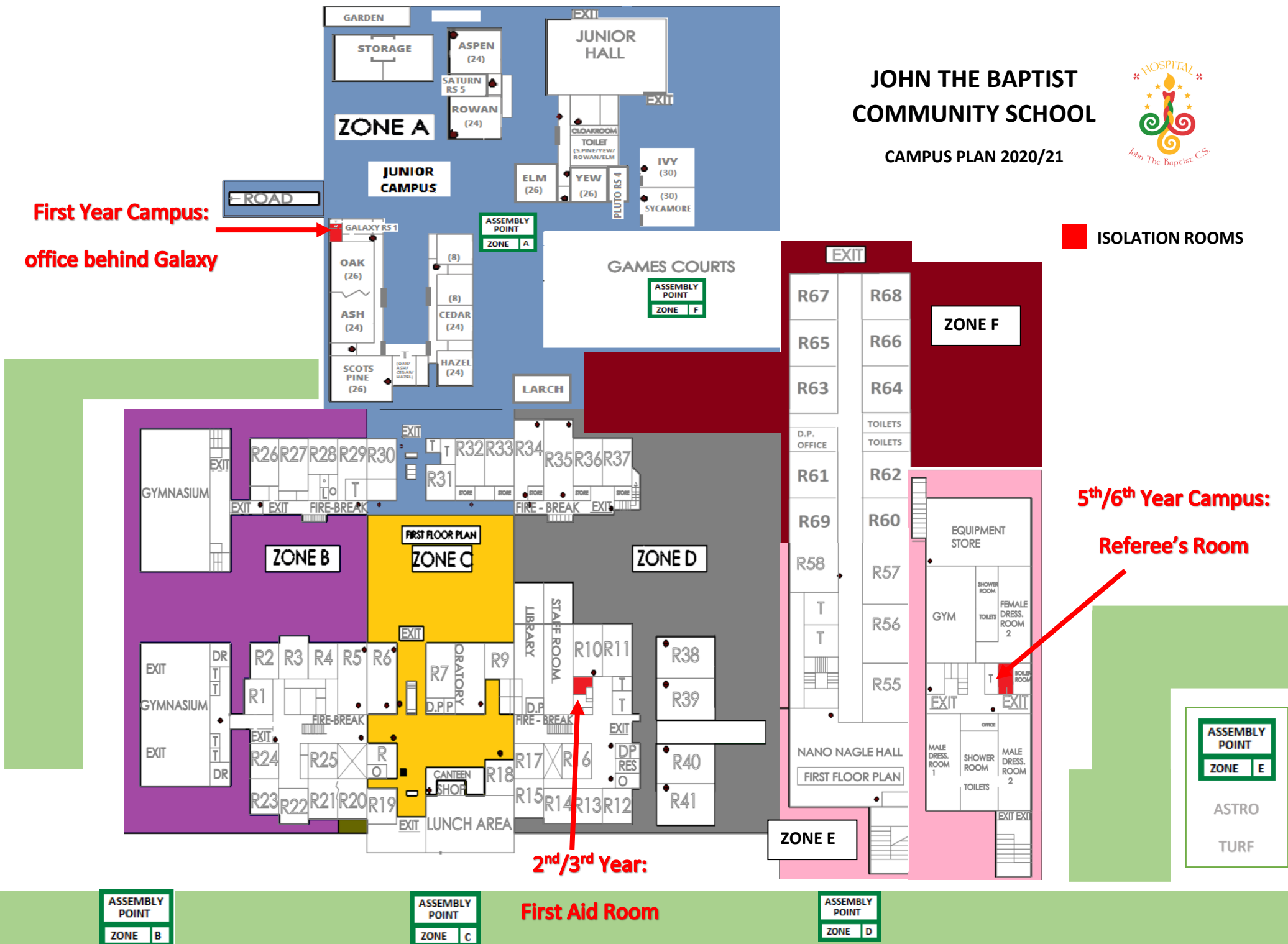

ASSEMBLY POINT  
ZONE B

ASSEMBLY POINT  
ZONE C

ASSEMBLY POINT  
ZONE D

ASSEMBLY POINT  
ZONE E  
ASTRO  
TURF